

OEI RX_ONE

Ø112 mm rear lights solution

New product 2023



We are OE Industry

We design and manufacture lighting systems for automotive and eMobility.

We help dozens of responsible vehicle manufacturers and other enthusiasts of safe transportation. To make their projects gain technological value in the market.

By doing so, we fill a niche in the mobility market. And we provide customers with safe, state-of-art solutions.

Design → Prototype → Production

A manufacturer who has been a supplier for years. Therefore, we understand your expectations perfectly and support – as constructively as possible – your possibilities. Meet a partner who will take full responsibility for your headlight.

→ We will design it exactly the way you need it.

→ let you get to know it on a prototype before making a final decision.

→ and eventually produce it! We are now the team responsible for the design and monitoring the production! So you have 100% conformity of the project and prototype with the final shape and functions of the headlight.

→ we will deliver the entire series to you on time and at the place indicated.

Need details?

1. / DESIGN – your headlight has been designed by our interdisciplinary design team at OEI Design LAB. The unique and stunning in every accent. Attracting attention and skilfully keeping it.

2. / PROTOTYPE - before you order – see yourself. Before you install – meet it. Let your purchase decision be informed, aware and unleash the full potential of your brand. At OEI, prototyping is a natural step of work. This is how we understand the new era of services for eMobility.

3. / PRODUCTION – a headlight manufactured under the supervision of the OE Industry is a guarantee of a standard that exceeds your expectations. Even those from the future.

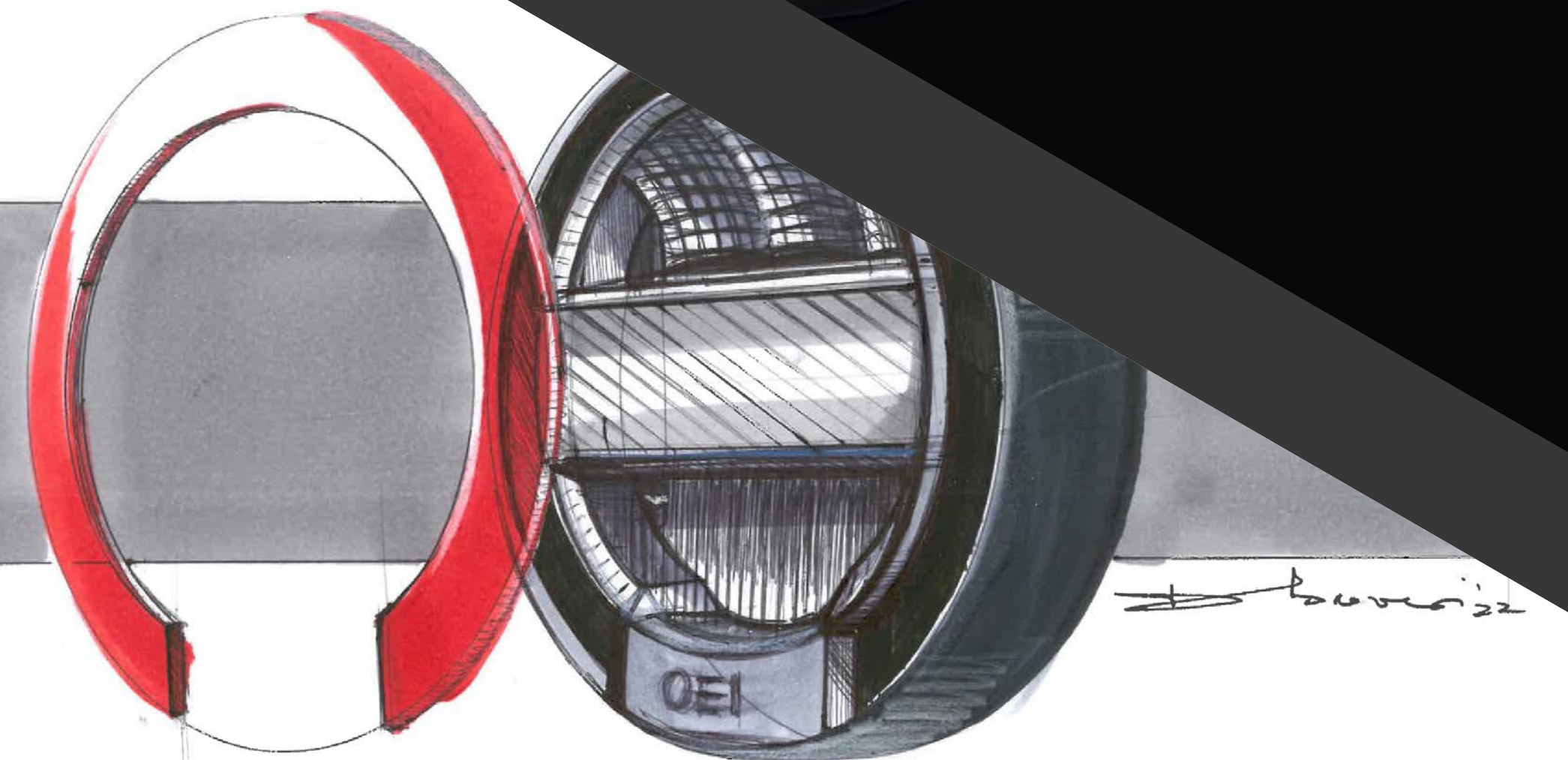

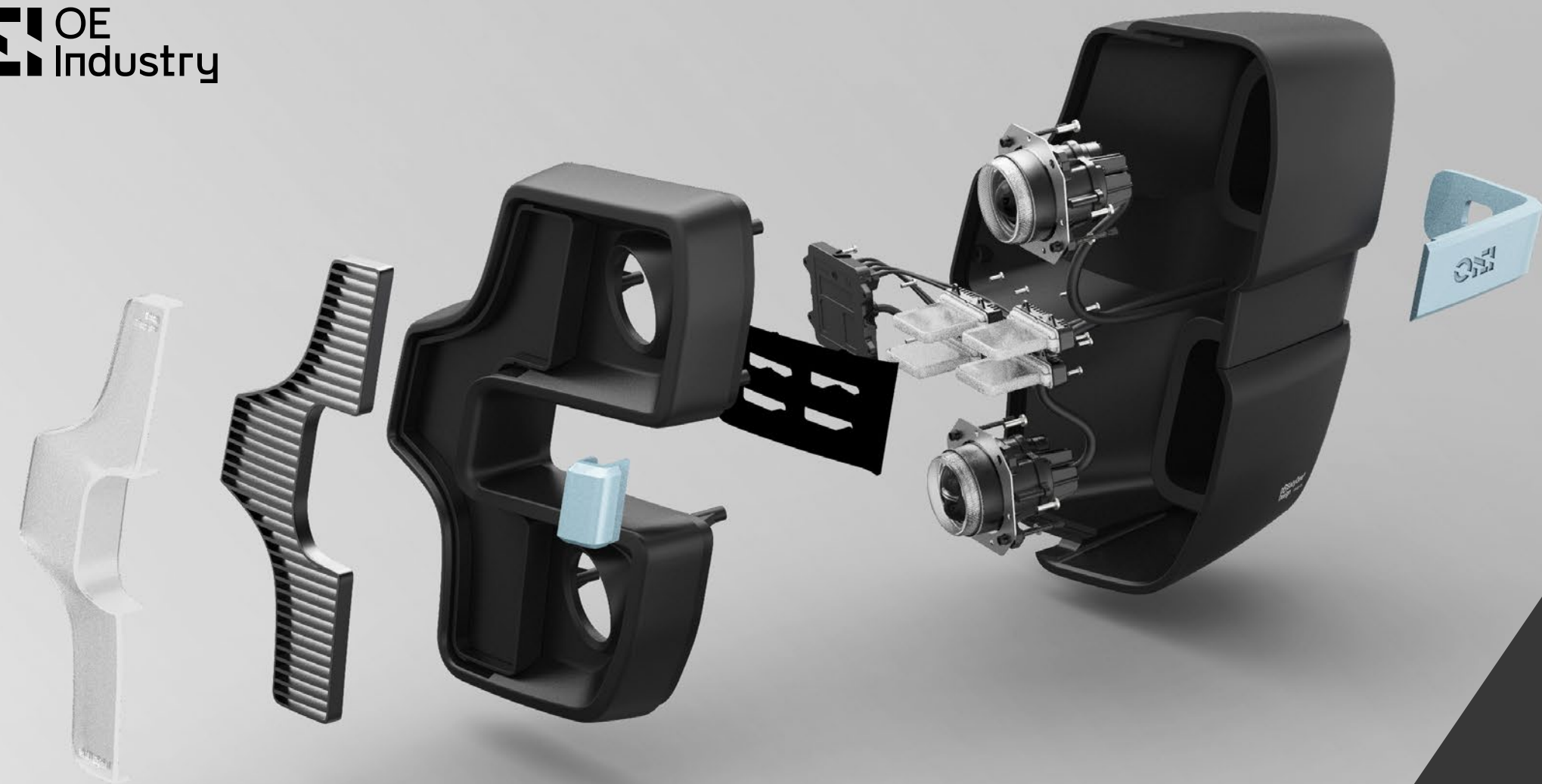

One light module. Many forms of expression.

It is said that lights are the eyes of a vehicle. They attract and hold attention. They are an element that can emphasize a brand's DNA more intensively than others.

That's why at OE Industry we design headlights in a very specific way. Consciously. While performing an important utilitarian function at the same time, they are supposed to bring out the full character of the entire vehicle. Because light is an art. And art is emotion.

At OE Industry, as early as the design concept stage of modular headlights, we think about their future display inside vehicles. We start each process with:

- analyzing trends in vehicle design,
- observation of the vehicle context,
- we draw on feedback from users.

Success designed with engineering precision.

We implement technical solutions right from the design phase. We have created our own implementation and development department. Because when you want to create products that change standards, you need to know where the industry will be in a year and in five years.

As a result, moving through the stages from initial concept to regular deliveries is even faster. In an atmosphere of awareness of your business goal and with full focus on your success.

At OE Industry, we make you feel confident and secure from the first day we work together. Your goals and wishes are also ours.

OE Industry will ensure your success. Better than you expect.

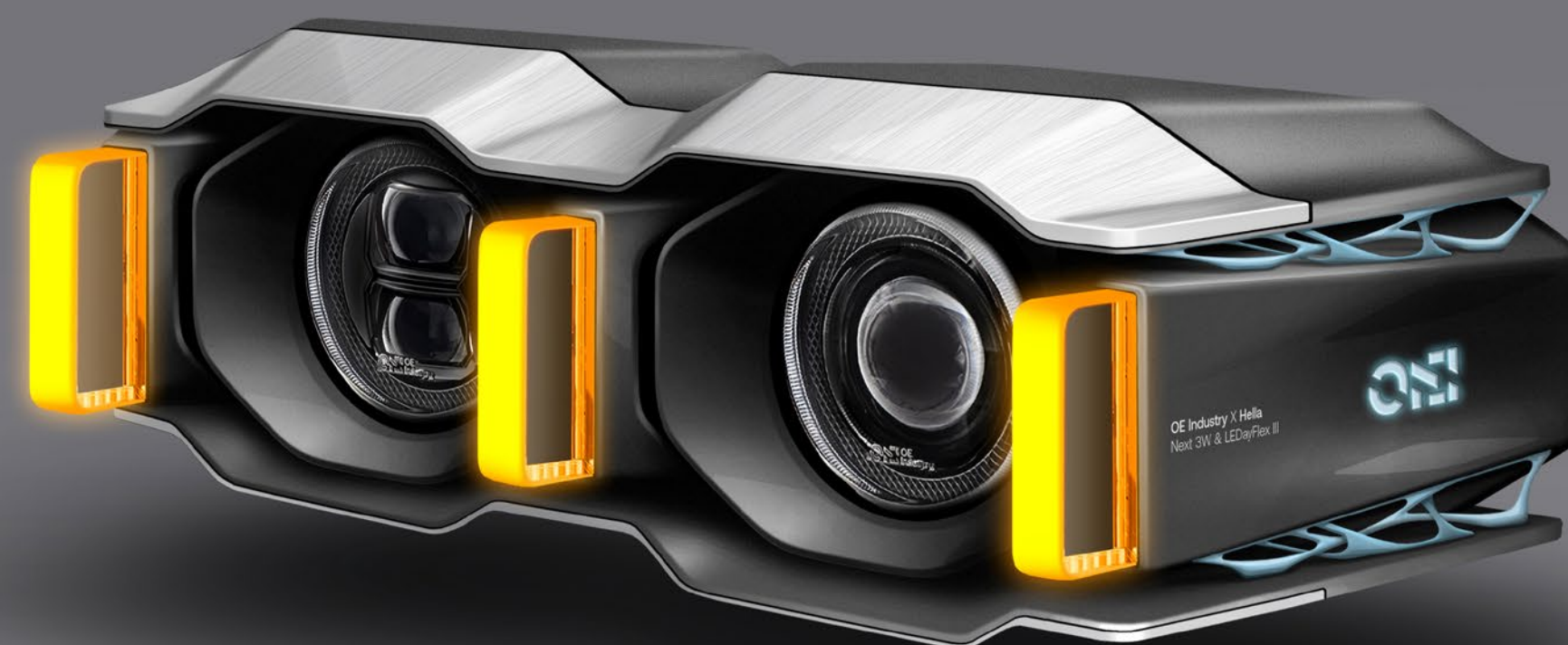

RX_One

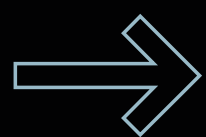

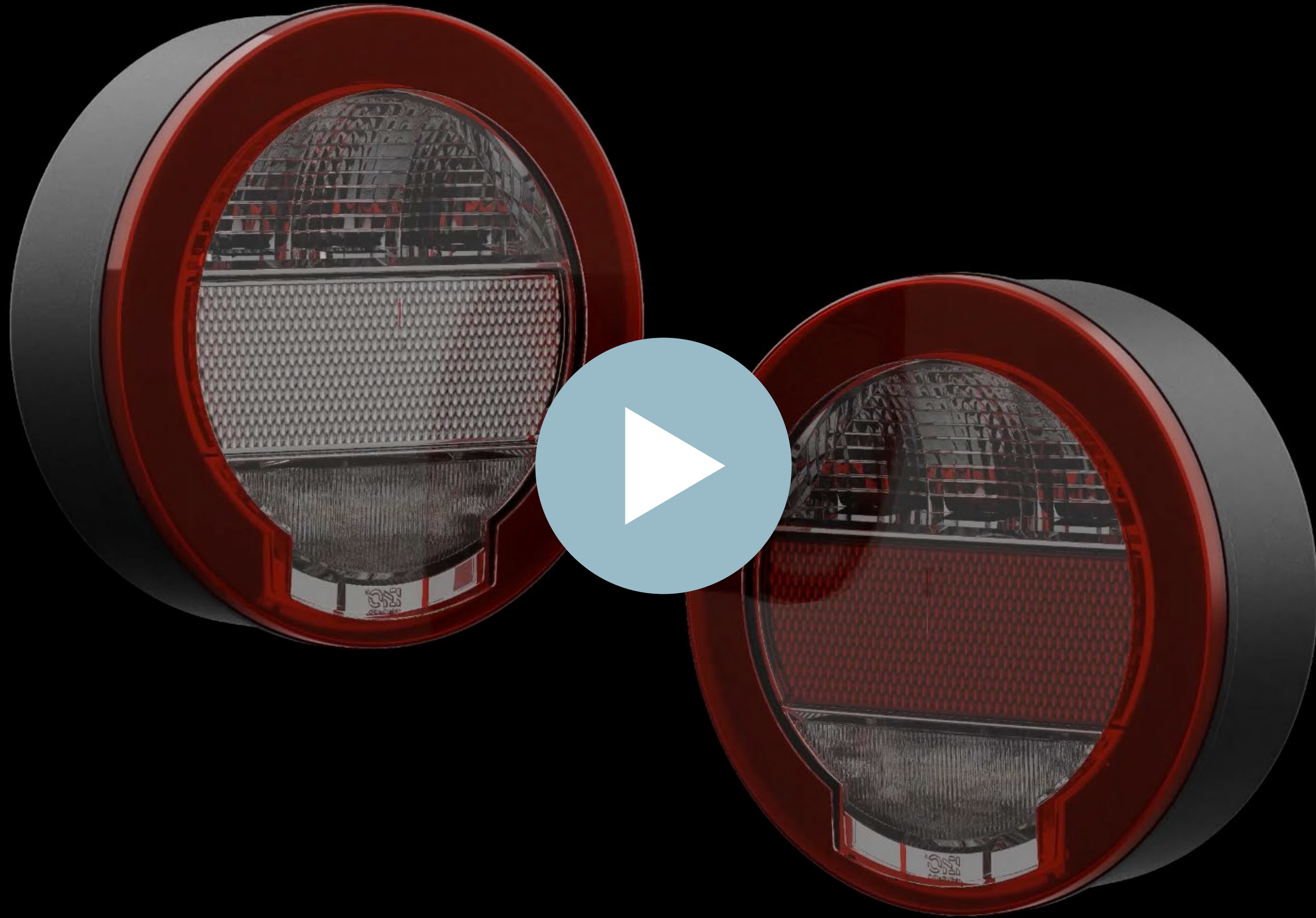

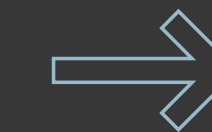

OEI RX_One :

One light system,
multifunctional hybrid aesthetics.

RX_ONE is a rear lamp with a 112 mm diameter based on hybrid technology.

What sets this lamp apart?

We designed it to give a homogeneous distribution of light - whose beams together form an understated, visually intriguing ring. We used RFT technology in the internal reflector. This gives the lamp the impression of extra depth just like in passenger vehicles.

RX_ONE is not a flat lamp, but a functional and stunning design essential for vehicle lighting. It is perfect for both small vehicles (1 or 2 lamps) and larger public transportation (4 lamps per side).

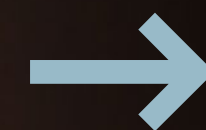

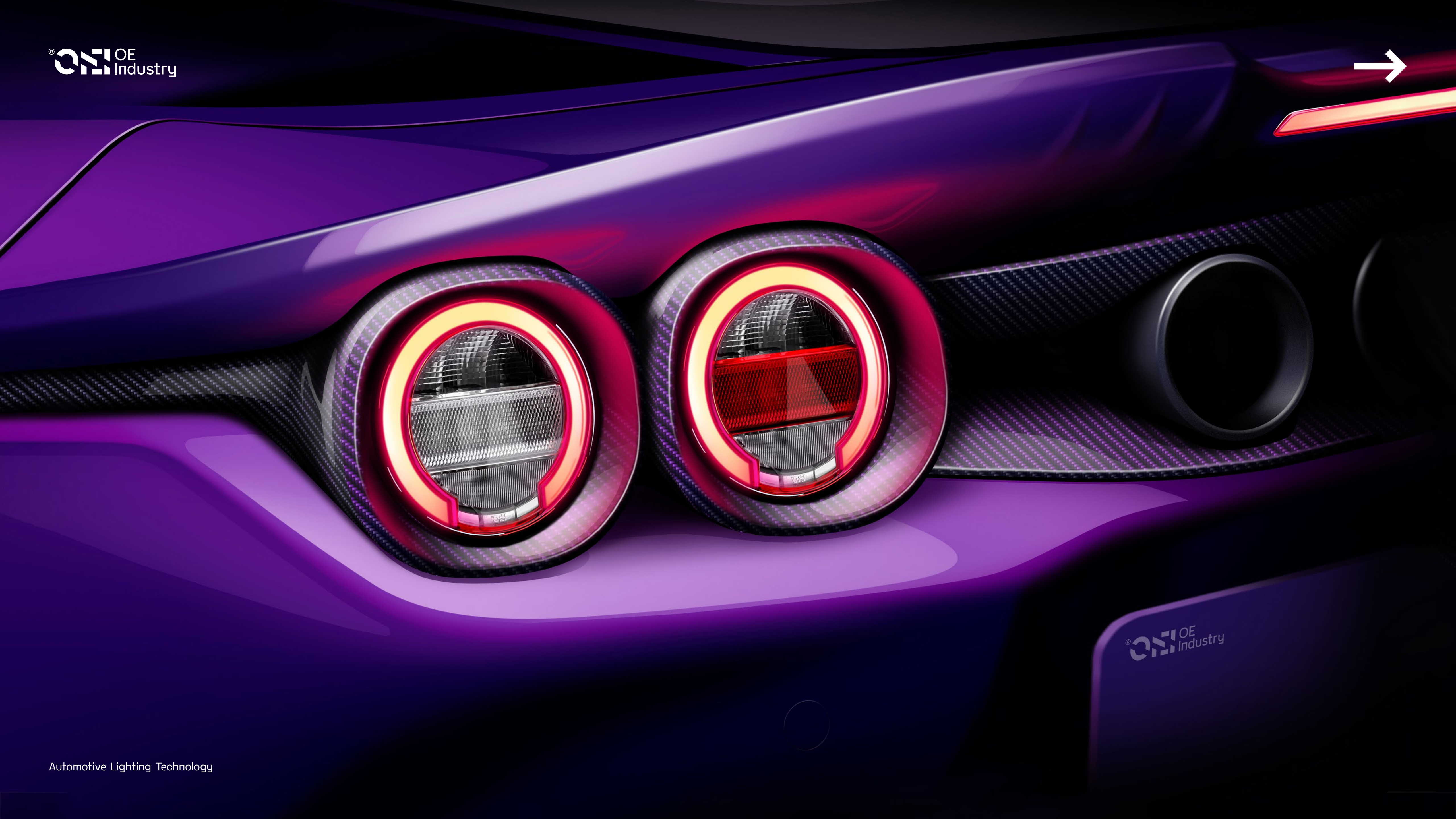

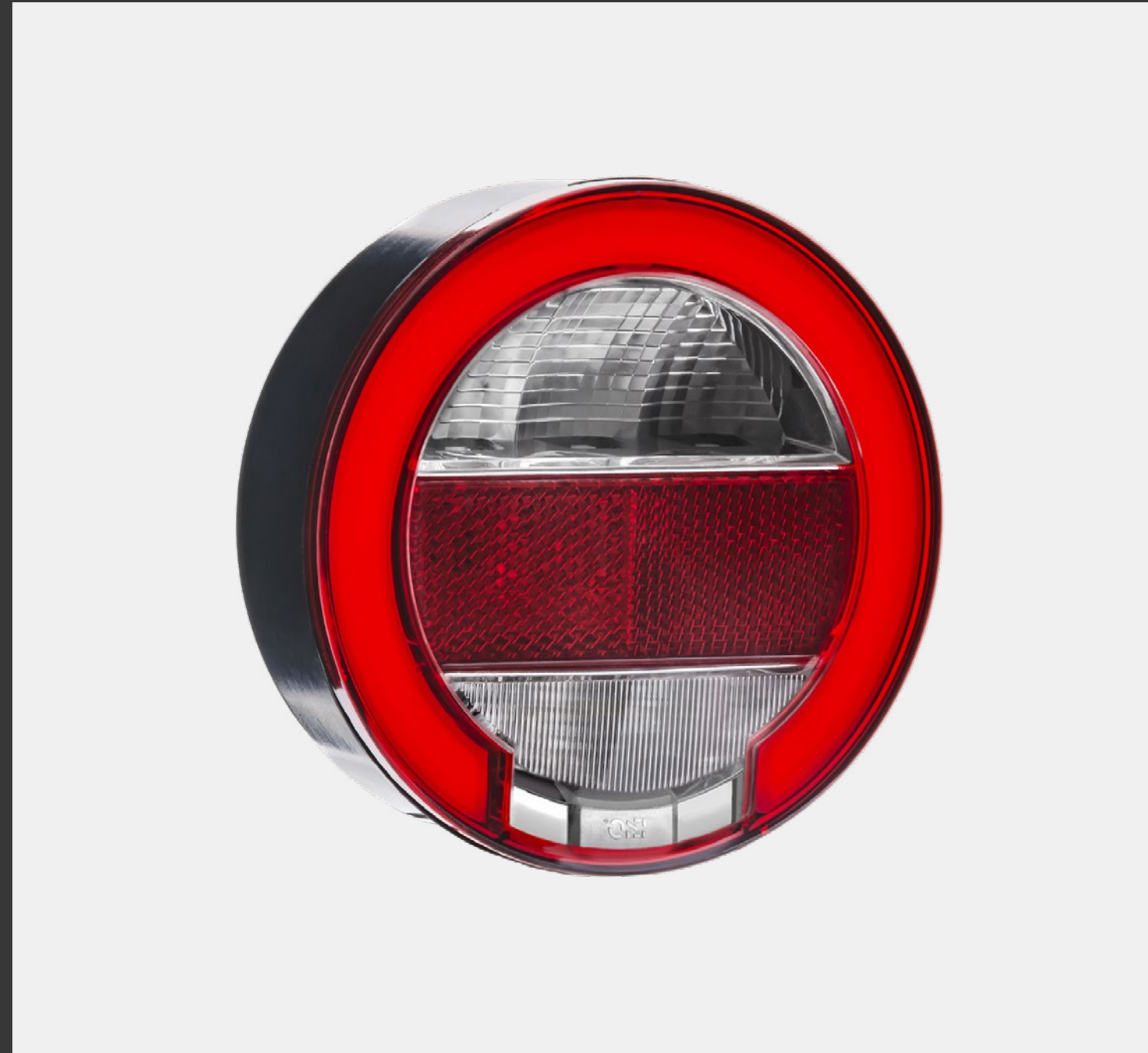

Technical data

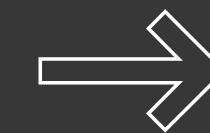

Source of light	LED
Voltage	12/24V
Dimensions	Ø112 mm
Connection	Superseal
IP Rating	IP67
Approvals	ECE R10, R148 R150

OEI262003620	stop, position, indicator
OEI262003621	fog light, reflex
OEI262003622	reversing light, reflex
OEI262003624	fog light, reversing light, position, reflex

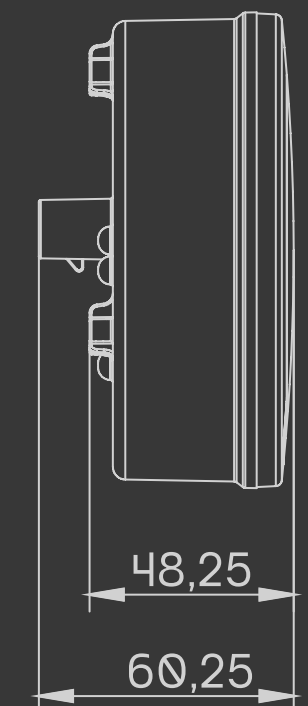
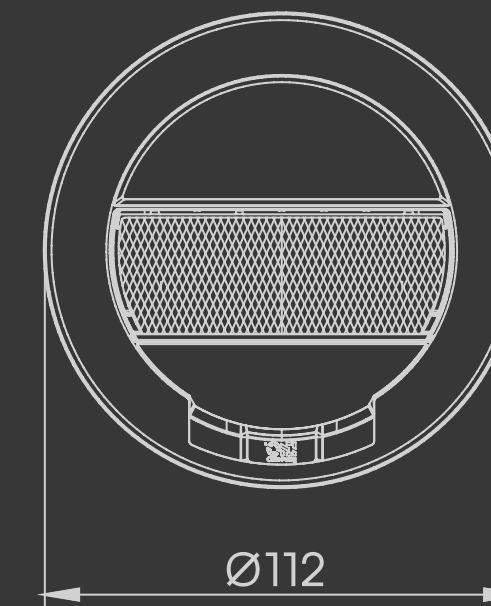



Let's talk!

OE Industry

Marcika 6 street
30-443 Cracow

biuro@oeindustry.com
+48 12 442 00 05

www.oeindustry.com

